

2 Phase Hybrid Stepping Motor

56C SERIES
56mm (NEMA23)



0.9° **Unipolar**

SPECIFICATIONS

MODEL	STEP ANGLE	VOLTAGE	CURRENT	RESISTANCE	INDUCTANCE	HOLDING TORQUE	ROTOR INERTIA	NUMBER OF LEADS	MASS	LENGTH
	deg.	V	A/φ	Ω /φ	mH/φ	mN-m	g-cm ²	Wires	g	mm
SST56C110X	0.9	5.3	1.0	5.3	7.0	460	120	6	0.45	39.4
SST56C320X	0.9	3.2	2.0	1.6	3.5	1029	245	6	0.71	54.5
SST56C530X	0.9	3.3	3.0	1.1	2.5	1569	470	6	1.10	76

Final Number 0:Single Shaft 1:Double Shaft

DIMENSIONS

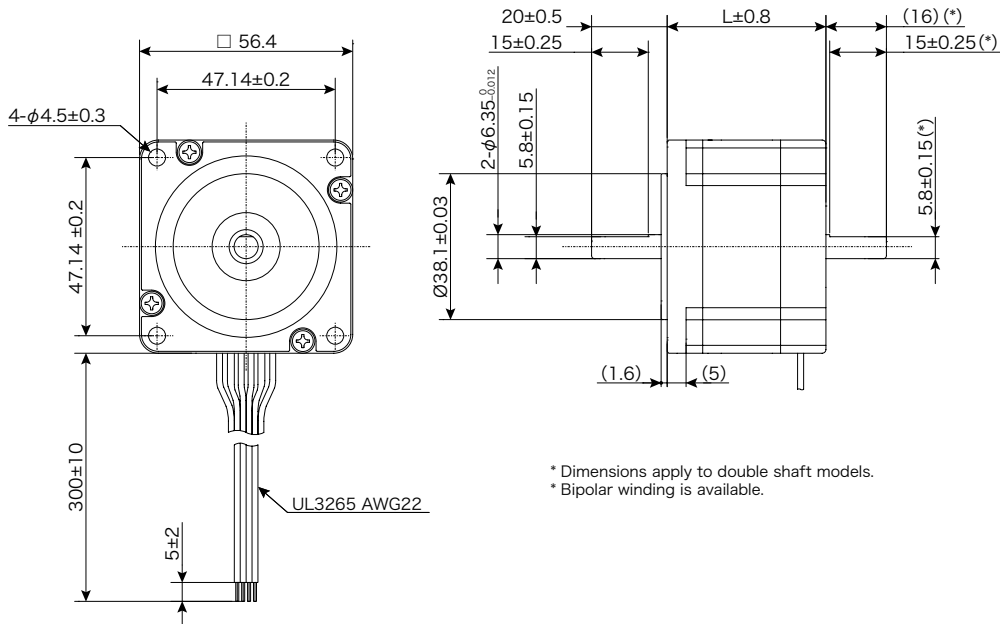

* Dimensions apply to double shaft models.
* Bipolar winding is available.

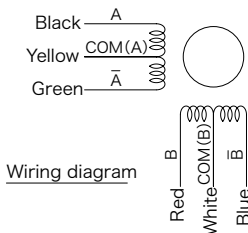

TORQUE RANGE

STEP ANGLE	SIZE		WINDINGS	MODEL	TORQUE (mN-m)*FREQUENCY at 1,000pps										
					0	50	100	200	300	400	600	800	1000	1500	2000
0.9°	56mm	NEMA23	Unipolar	56C1	[Torque range bar from 200 to 350]										
				56C3	[Torque range bar from 400 to 700]										
				56C5	[Torque range bar from 600 to 1000]										

PULL OUT TORQUE CURVE

SST56C1100

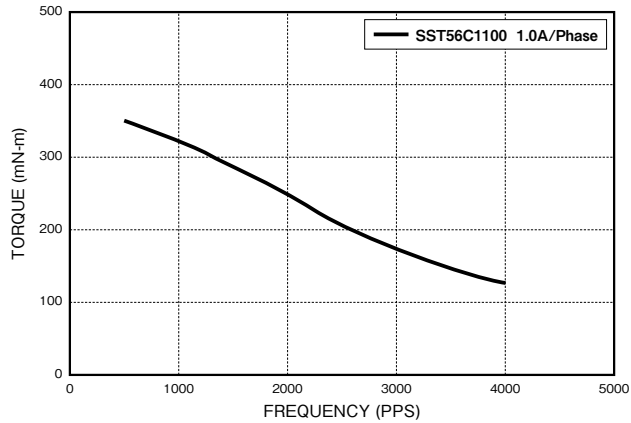

DRIVER Chopper
 SUPPLY VOLTAGE DC24V
 EXCITING MODE = 2 Phase
 MOUNTING with rubber damper

SST56C3200

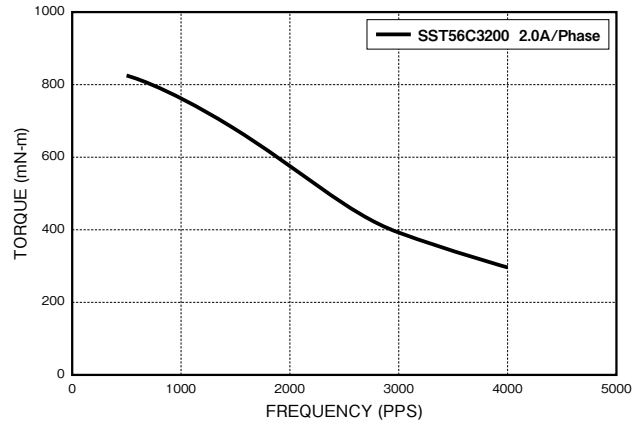

DRIVER Chopper
 SUPPLY VOLTAGE DC24V
 EXCITING MODE = 2 Phase
 MOUNTING with rubber damper

SST56C5300

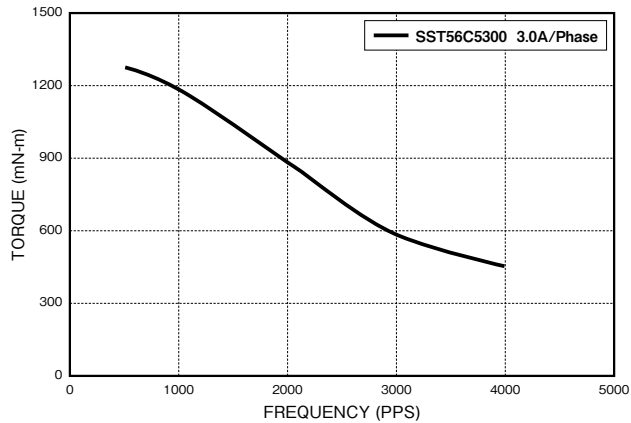

DRIVER Chopper
 SUPPLY VOLTAGE DC24V
 EXCITING MODE = 2 Phase
 MOUNTING with rubber damper

i Modified shaft, custom winding and other modifications are available. Please feel free to contact sales office or sales agent.

! Operate the motor keeping the motor surface temperature at 100 deg. C or lower.